

MECHANICAL PLAN - DUCTWORK

1/8" = 1'-0"  
101

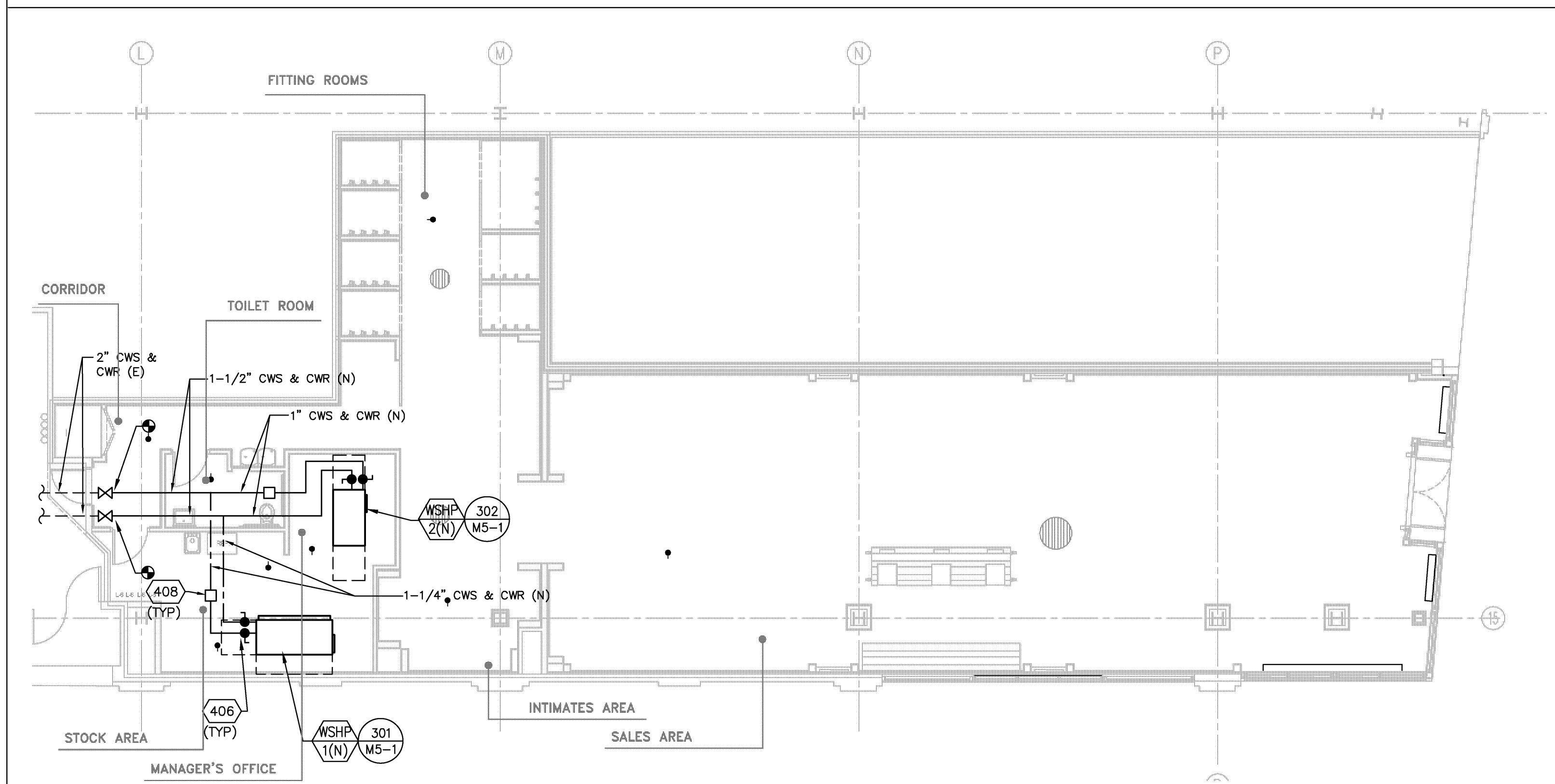

MECHANICAL PLAN - PIPING

1/8" = 1'-0"  
100

**DUCTWORK SUBMITTAL REQUIREMENTS**

1. ALL ROUND AND FLAT OVAL SUPPLY, RETURN AND EXHAUST DUCTWORK SHALL BE LINDAB, UNITED MCGILL OR SEMCO DUCT SYSTEMS CONSISTING OF FITTINGS THAT ARE FACTORY FITTED WITH A SEALING GASKET AND SPIRAL DUCT WHICH, WHEN INSTALLED ACCORDING TO MANUFACTURER'S INSTRUCTIONS, WILL SEAL THE DUCT JOINTS WITHOUT THE USE OF DUCT SEALER. MATERIALS: ALL DUCT AND FITTINGS SHALL BE G-90 OR G-60 GALVANIZED.
2. SUBMITTALS: SUBMIT MANUFACTURER'S DUCT SYSTEM CATALOG DATA FOR REVIEW AND APPROVAL. SUBMITTAL SHALL INCLUDE DUCT, FITTING AND SELF SEALING GASKET CATALOG INFORMATION.
3. FOR GAP INC. NEGOTIATED NATIONAL ACCOUNT PRICING, CONTACT: LINDAB NATIONAL ACCOUNT REP - LARRY SMITH P. E. BWALTER@MCGILLAIRFLOW.COM OFFICE: 800-797-7476 EXT. 2033  
UNITED MCGILL ACCOUNT REP - BRUCE WALTERT BWALTERT@MCGILLAIRFLOW.COM OFFICE: 209-466-2351 CELL: 916-533-5582

CHANGES TO THE DESIGN OF ANY SYSTEM IDENTIFIED ON THESE DRAWINGS OR SPECIFICATIONS SHALL BE SUBMITTED TO THE ENGINEER OF RECORD FOR REVIEW AND APPROVAL PRIOR TO THE FABRICATION AND INSTALLATION. ANY MODIFICATIONS WITHOUT THE ORIGINATING ENGINEER'S WRITTEN AUTHORIZATION AND APPROVAL SHALL BE THE RESPONSIBILITY, AS WELL AS THE COST TO CORRECT SUCH MODIFICATION, OF THE CONTRACTOR.

6.

**HVAC PLAN NOTES**

1. ALL RETURN GRILLES IN CONSTRUCTION AREAS MUST BE COVERED WITH FILTER MEDIA WHILE HVAC SYSTEM IS RUNNING DURING CONSTRUCTION. REPLACE FILTER MEDIA WHEN IT GETS DIRTY.
2. CONTRACTOR IS RESPONSIBLE FOR CLEAN HVAC COILS AT THE END OF CONSTRUCTION. PREVISIONS SHOULD BE TAKEN TO KEEP COILS CLEAN, AND IF COILS GET DIRTY, THEN CONTRACTOR IS RESPONSIBLE FOR CLEANING THEM.
3. DURING A PHASED REMODEL, AIR SHALL NOT RETURN TO A FINISHED SPACE FROM A CONSTRUCTION ZONE. CONTRACTOR TO RUN TEMPORARY FLEX DUCT AND SEAL OFF CONSTRUCTION AREAS AS REQUIRED TO INSURE THIS.
4. CERTIFIED TAB CONTRACTOR TO REBALANCE EXISTING AIR DEVICES TO CFM AS DESIGNATED ON PLAN.
5. MOUNT EQUIPMENT AND DUCTWORK AS HIGH AS POSSIBLE. EQUIPMENT AND DUCTWORK TO BE AT LEAST 13'-8" AFF.
6. CONTRACTOR SHALL VERIFY WITH LANDLORD THE REMOVAL OF ALL EQUIPMENT OR PIPING PRIOR TO DEMOLITION OR CONSTRUCTION.
7. CONTRACTOR SHALL VERIFY WITH LANDLORD ANY EXISTING EQUIPMENT TO BE REMAIN AND BE REUSED.
8. CONTRACTOR SHALL VERIFY ROUTING AND SERVICE OF ANY PIPING OR EQUIPMENT WHICH IS EXTERNAL TO THE DEMISED PREMISES.
9. ACCESS PANELS IN CEILING MUST BE LOCATED TO PROVIDE ACCESS TO LANDLORD'S EQUIPMENT, VALVES, CONTROLS, DAMPERS, CLEANOUTS, JUNCTION BOXES, ETC THAT ARE CONCEALED ABOVE CEILING.
10. INSPECT EXISTING CONDITION OF OPEN PLENUM AT DEMISING WALLS. GC TO VACUUM CLEAN ANY DUST ON GRILLES OR WIRE MESH SEPARATING TENANT SPACES TO ASSURE PROPER RETURN AIR MOVEMENT. COORDINATE THIS WORK WITH MALL OPERATIONS MANAGER.
11. COVER RETURN AIR OPENINGS BEFORE AND DURING CONSTRUCTION.
12. ALL ROOF PENETRATIONS MUST BE BY LANDLORD'S ROOFER AT GC'S EXPENSE.

**REVISION 1 SUMMARY**  
A. ADDITIONAL GENERAL NOTES PER LANDLORD.

**HVAC CODED NOTES**

- 100 PLACE "AS-BUILT" MECHANICAL DRAWINGS IN DRAWING TUBE. REFER TO SPECIFICATIONS FOR ADDITIONAL REQUIREMENTS.
- 101 DASHED LINE AROUND HVAC EQUIPMENT REPRESENTS MANUFACTURER'S RECOMMENDED CLEARANCES FOR EQUIPMENT MAINTENANCE. IT IS THE MECHANICAL CONTRACTOR'S RESPONSIBILITY TO MAINTAIN SERVICE CLEARANCES THE FULL HEIGHT OF THE UNIT IN THIS AREA AND TO PROVIDE ACCESS TO THESE AREAS SUBJECT TO G.C.'S APPROVAL. SHOULD FREE AREA NOT BE AVAILABLE, CONTACT G.C.'S FOR FURTHER INSTALLATION REQUIREMENTS
- 102 CONTRACTOR TO PROGRAM HVAC EQUIPMENT THERMOSTAT, INITIAL OPERATION HOURS AND TEMPERATURE SET POINTS. ADJUST OPERATIONAL HOURS WHEN OBTAINED BY GENERAL CONTRACTOR.
- 104 PROVIDE NEW COMMERCIAL PLEATED AIR FILTERS 2" DEEP WITH MERV 7 RATING AT EACH OF THE FOLLOWING TIMES. FILTERS SHALL BE FARR 30/30 OR APPROVED EQUAL:
  1. INSTALL FIRST SET OF 2" PLEATED FILTERS DURING UNIT INSTALLATION.
  2. REPLACE FILTERS AFTER ANY HEAVY SANDING OR OTHER CONSTRUCTION ACTIVITY THAT WOULD ADD DIRT TO FILTERS.
  3. INSTALL CLEAN FILTERS JUST PRIOR TO AIR BALANCE.
  4. INSTALL FINAL FILTERS AFTER FINAL STORE CLEANING.
- 300 VENSTAR T2900 PROGRAMMABLE THERMOSTAT. THE MOUNTING HEIGHT SHALL BE 48" A.F.F. CONFIRM EXACT LOCATION WITH G.C. PRIOR TO ROUGH-IN.
- 301 VENSTAR ACC0400 REMOTE TEMPERATURE SENSOR. THE MOUNTING HEIGHT SHALL BE 48" A.F.F. CENTERED ON COLUMN. CONFIRM EXACT LOCATION WITH G.C. PRIOR TO ROUGH-IN. INSTALL CONTROL WIRING IN CONDUIT. ATTACH SENSOR TO ROUGHED-IN ELECTRICAL J-BOX.
- 304 SYSTEM SENSOR MODEL D4120 DUCT MOUNTED SMOKE DETECTOR. WIRE THE THERMOSTAT FAN WIRE THROUGH THE NORMALLY CLOSED CONTACT ON THE SMOKE DETECTOR TO SHUT DOWN THE HVAC UNIT UPON SENSING SMOKE. SMOKE DETECTOR MUST BE INSTALLED IN AN ACCESSIBLE LOCATION IN SUPPLY AND/OR RETURN WHEN REQUIRED BY CODE. INSTALL REMOTE TEST/RESET STATION, SYSTEM SENSOR MODEL RTS151KEY, AS REQUIRED. COORDINATE LOCATION OF TEST STATION WITH G.C.
- 309 AIR DEVICE TO BE USED AS ACCESS TO EQUIPMENT ABOVE CEILING. VERIFY THAT SWING OF DEVICE WILL NOT INTERFERE WITH OTHER CEILING ELEMENTS.
- 311 PROVIDE 24"x24" ACCESS DOOR IN CEILING TO ACCESS MECHANICAL, ELECTRICAL, PLUMBING EQUIPMENT, SMOKE DETECTORS, ETC.
- 400 WATER SOURCE HEAT PUMP. SUSPEND FROM STRUCTURE WITH IN-LINE COMBINATION RUBBER AND SPRING VIBRATION ISOLATORS.
- 401 SUPPLY AND RETURN AIR DUCT CONNECTIONS TO HEAT PUMP SHALL BE FULL SIZE OF EQUIPMENT OPENINGS AND PROVIDED WITH FLEXIBLE DUCT CONNECTIONS. DUCTWORK SHALL BE INSTALLED FROM UNIT CONNECTIONS FULL SIZE FROM THE UNIT FOR A MINIMUM DISTANCE OF 4 FEET HORIZONTALLY PRIOR TO ANY DOWNSTREAM FITTINGS. ELBOWS SHALL HAVE DOUBLE THICKNESS TURNING VANES INSTALLED.
- 402 INSTALL (1) TRANSFER GRILLE ON STOCKROOM SIDE OF WALL AT 17'-0" A.F.F. TO BOTTOM OF GRILLE. MOUNT "UP-SIDE-DOWN" TO PREVENT VIEW THROUGH DEVICE. PAINT TO MATCH WALL.  
ROUTE TOILET EXHAUST TO EXISTING 12"x12" EXHAUST DUCT. INSTALL BACKDRAFT DAMPER AT CONNECTION. CAP EXISTING EXHAUST DUCT AIRTIGHT.
- 404 RETURN GRILLE MOUNTED IN CEILING OF RECESSED ENTRYWAY. COORDINATE LOCATION WITH LIGHTS AND ARCHITECTURAL CROWN MOLDING. COORDINATE PAINT COLOR WITH ARCHITECT.
- 405 THE OSA MOTORIZED DAMPER ON THE MIXING BOX TO OPEN WHEN WSHP IS IN OCCUPIED MODE. DAMPER TO OPEN TO ALLOW REQUIRED OUTDOOR AIR AS SPECIFIED IN VENTILATION SCHEDULE ON SHEET M4-0.
- 406 CONDENSER WATER PIPING CONNECT TO NEW WSHP. ROUTE PIPING TO CONNECT TO EXISTING 2" CONDENSER WATER SUPPLY AND RETURN.
- 407 MIXING BOX. DAMPER ACTUATORS TO BE POWERED THROUGH THE WSHP CONTROL BOARD.
- 408 FLOW METER. REFER TO M5-1 FOR MORE INFORMATION.

NOTE TO CONTRACTOR:  
SEE "GENERAL SHEETS" IN THIS SET FOR RESPONSIBILITY MATRIX ITEMS AND REFER TO SPECIFICATION BOOK FOR GENERAL NOTES.

NEW STORE

**ATHLETA**

GAP INC.  
CORPORATE ARCHITECTURE  
1 HARRISON STREET  
SAN FRANCISCO, CA 94105

STORE NO.: 7043

STORE NAME:  
VILLAGE OF MERRICK PARK

STORE LOCATION:  
350 SAN LORENZO AVE  
CORAL GABLES, FL 33146

CONSTRUCTION TYPE: 2B

PROJ. I.D.: 0000048612

PROTOTYPE DATE: 06/25/12  
PROTOTYPE VERSION 2.1  
OPENING 2013

REVISION 1: 11/20/12

CONSULTANT INFO:

PROFESSIONAL STAMP:

ARCHITECT INFO:  
**PHILLIPS**  
NORTH TERRACES  
400 PERIMETER CENTER TERRACE  
SUITE 650  
ATLANTA, GA 30346

ISSUE TYPE:  
PERMIT AND BID SET 10/19/12

DRAWN BY: TAN  
A&E JOB NO.: 1201330

SHEET TITLE:  
MECHANICAL PLANS

SHEET NUMBER:  
**M1-0**